

# 1" STAINLESS STEEL TANK TEES

## ALL 304 STAINLESS STEEL

### SPECIFICATIONS:

- Tank tee connects the water line from the pump to the pressure tank plus all the extra tapings needed to complete installation.
- Several lengths available for use with various pressure tanks: 4-1/2", 5-1/2", 6", and 11".
- Several tank connections available: 1" MIP, 1" FIP, 1-1/4" MIP, 1-1/4" FIP.
- Other tapings provided: front drain hole (2) 1/2" FIP for 1" size tees and (2) 3/4" FIP for 1-1/4" size tees.
- Lateral connections for pipe to and from tank: 1" MIP and 3/4" FIP.
- All tank tees have two 1/4" FIP tapings on top of the tee, for pressure switch and pressure gauge.
- Tank tees are available as one piece, with O-ring union on tank leg.
- Long version tank tees available as all cast or fabricated with stainless steel pipe to give you the length needed.
- 12 different models of Stainless Steel Tank Tees for any model pressure tank or installation needs.



No Lead



C.A. Certified

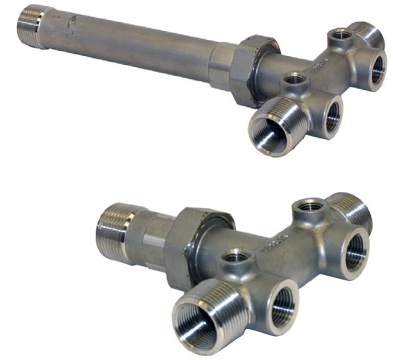

### CERTIFICATIONS:

- IAPMO CA. Certified

MATERIALS LIST	
Part Name	Material
Tank Tee Body	304 Stainless Steel
O-Ring	NBR (Nitrile)

DIMENSIONS										
Part No.	Type	Tank Connection	Lateral	Drain Hole (Qty/Size)	L in.	W in.	H in.	O-Ring Size	Ctn. Qty.	Approx. Wt./Lbs.
SSAT1002UCS	CAST	1" MIP	1" MIP & 3/4" FIP	(2) 1/2"	5.52	5.83	2.02	OR216	4	1.9
SSAT1002UC	CAST	1" MIP	1" MIP & 3/4" FIP	(2) 1/2"	10.90	5.57	2.05	OR216	2	2.7
SSAT1002S	CAST	1" MIP	1" MIP & 3/4" FIP	(2) 1/2"	4.34	5.53	1.50	N/A	4	1.4
SSAT1002	CAST	1" MIP	1" MIP & 3/4" FIP	(2) 1/2"	11	5.58	1.59	N/A	2	2.3
SSAT1002SF	FAB	1" FIP	1" MIP & 3/4" FIP	(2) 1/2"	6	5.46	1.54	N/A	4	2.2

**Note:** For leak proof threads with stainless steel, be sure to use Merrill AQUA-SEAL Thread Sealing Compound and PTFE-Tape with nickel.